

COPRECI S. COOP.
Avda. de Álava 3
E-20550 Aretxabaleta Guipúzcoa - SPAIN
Tel: +34 943 71 94 99
Fax: +34 943 79 23 49
home@copreci.es

COPRECI - ALTSASUKO S.COOP.
Txunkai Auzoa, Ibarrea 2 Industrialdea
Altsasu, 31800
SPAIN
Tel: +34-948-563-172
Fax: +34-948-563-496

COPRECI DE MEXICO, SA DE CV
C/ Uno, nº 736 Z.I. Guadalajara
44940 Jalisco - MEXICO
Tel: +52 33 3881-1170
Fax: +52 33 3881-1193

COPRECI DO BRASIL, LTDA.
Av. Eurico Ambrogi Santos, 1900 A
Distrito Industrial Piracangagua CEP 12010-970
Taubaté SP - BRAZIL
Tel: +55 12 3627-7200
Fax: +55 12 3627-7201

COPRECI CZ, S.R.O.
Komenského 274 79368
Dvorce u Bruntálu - CZECH REPUBLIC
Tel: +420 554 773 420
Fax: +420 554 773 446

COPRECI SYSTEMS, S.R.L.
Centrale: Via G. Galilei, 12 31010
Mareno di Piave (TV) - ITALY
Tel: +39 0438492531
Fax: +39 0438492559

COPRECI TR.LTD.STI.
GEPOSB Cumhuriyet Caddesi, 6 cadde.
Gebze-Kocaeli - TURKEY
Tel: +90 262 751 13 34
Fax: +90 262 751 42 56

COPRECI CHINA
South Side of Jinhai Road, Middle Section
Sanzao Hi-Tech Industrial Park
519040 Zhuhai - CHINA
Tel: +86 (0) 756 399 72 66/67/68
Fax: +86 (0) 756 399 72 69

MONDRAGON COMPONENTES USA, CO.
2621 Sandy Plains Rd. Suite 303
Marietta, GA, 30066
USA
Tel: +1 (678) 560-2154
Fax: +1 (678) 560-2153

Copreci, the heart of your appliance

Components for washing machines, dishwashers and dryers.



www.copreci.com
www.green-induction.com
www.safeandsmartcooking.com





What makes us different

In addition to a deep knowledge of the washing process, we provide a whole range of products for water management in washing machines, dishwashers and electric dryers and also valves for gas dryers.

Because we are there, in the soul of the domestic appliance, providing intangible added value, which goes straight to the user's heart.



"Copreci's right there inside, where no-one can see, but you can feel it.... making sure that everything works in perfect harmony..."

efficiency



Self adjustment of the flow rate independent of the pressure drop



Our components allow efficient water management.



CAE (Computer Added Engineering) for operating simulation

quality



Quality assurance



Innovation capacity



Control redundancy



Continuous improvement team



Product traceability

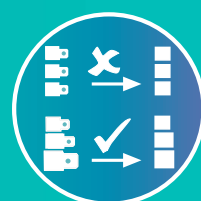

Poka-yoke system



Continuous measurements over the entire manufacture



Short-term reliability testing: simulation of 2 years of the life of the pump



Statistical control





Lower noise level

At Copreci we aim for a noiseless home where you can even hear the silence. To achieve this, we have developed technological components that contribute to this aim. ➡

can you hear the

silence?

1 BLDC Drain Pump Technology

Owing to the BrushLess-DC motor technology we get noise levels well below those achieved with synchronous motors*.

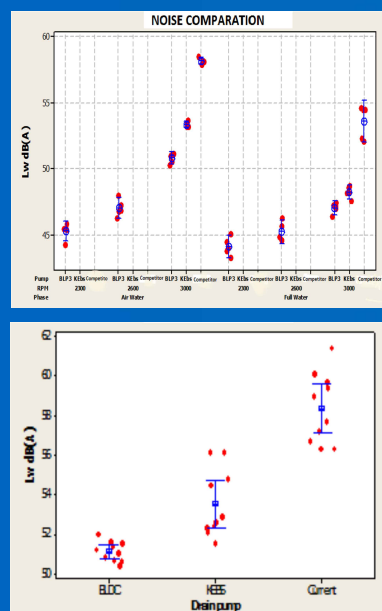

* Depends on the used washing machine model

2 TCM (Triac control mode)

The use of TCM patented technology reduces noise of synchronous drain pumps during the white-water phase. Our laboratory measurements show an improvement of 2dB compared to standard pump control systems*.

* Depends on the used washing machine model

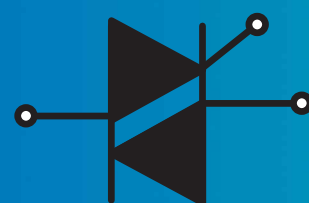

3 Powertrain Copreci - Elsa System

Since 2000, Copreci supplies pumps including the patented ELSA system (Enhanced Life Shock Absorber) allowing a quieter drain pump solution (2dB*) while increasing the useful life of the component.

*Depends on the analysed machine type

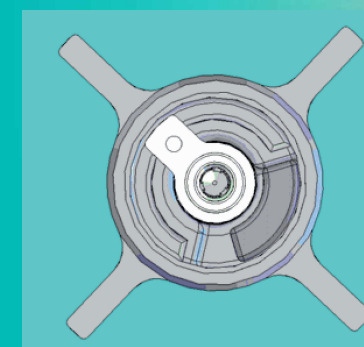
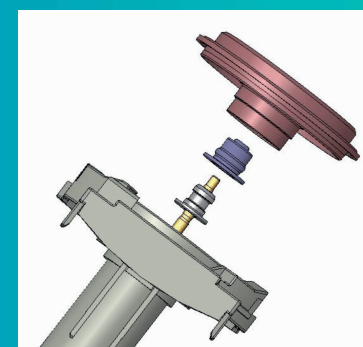

4 Smart Draining

Our expertise in hydraulics and in PMSM motor controls (e.g. patented Smart Draining algorithm) allow us to design our pumps with a significant noise reduction in "whitewater" phase (an effect also known as "snorkel").



Silent pumps, looking for noise-free solutions

Products overview

Washing machine requirements ➡



Drain Pump:

Flow rate: 18l/min up to 40 l/m
Pressure drop: 1 or 2m (2m U.S.)
Power supply: 220V/50Hz 120V/60Hz
Technologies: Synchronous/BLDC-AC

Recirculation Pump:

Flow rate: 9l/min
Pressure drop: 1m
Power supply: 220V/50Hz 120V/60Hz
Technologies: Synchronous/BLDC-AC

Dishwasher requirements



Drain Pump:

Flow rate: 15l/min
Pressure drop: 1m
Power supply: 220V/50Hz 120V/60Hz
Technologies: BLDC/Synchronous

Recirculation Pump:

Flow rate: 40l/min
Pressure drop: 4m
Power supply: 220V/50Hz 120V/60Hz
Technologies: BLDC

Gas dryers



Gas valve - Skt series:

Gas valves for domestic appliances such as gas dryers with hot surface ignition system. It combines an adjustable pressure regulator and two solenoid valves, the main and the redundant.



Technologies

Synchronous

Traditional technology for pumping water in household appliances. A bi phasic motor working at constant speed, that includes a clutch in the impeller allowing to overcome the low starting torque.

Advantages:

Simple technology
Clutch built into impeller
Plug n' Play (no electronic needed)
Low Noise

BLDC-AC

Electronically controlled three phase drain pump, making it work at different speed profiles, reduce noise level, deblocking function.. in order to optimize household appliance's performance.

Advantages:

High starting torque (no clutch)
Very low noise
Optimized heat dissipation
Different V/f power supplies
Improved hydraulic performances
Different operating points/torque/speed
Deblocking sequences
Compact Design
Sensored application
Intelligent behavior
Low energy consumption



KEBS (20mm stack)
Hydraulic power 1-3W



EBS (25mm stack)
Hydraulic power 1-5W



BEBS (40mm stack)
Hydraulic power 2-8W

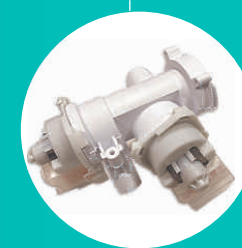

**Drain pump +
recirculation pump**



BLP3
Hydraulic power 1-5W



Recirculation
Hydraulic power 5-30W

KEBS

Stator Stack 20 mm.

Smallest Pump, suitable for all drain applications up to 1m of pressure drop.

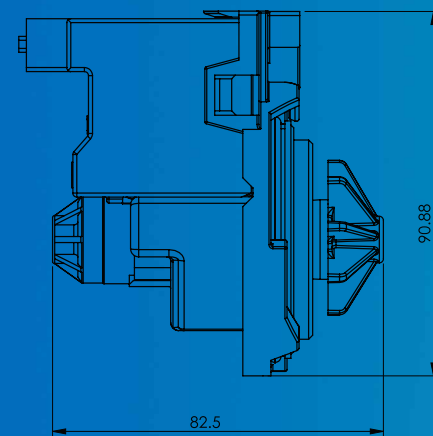
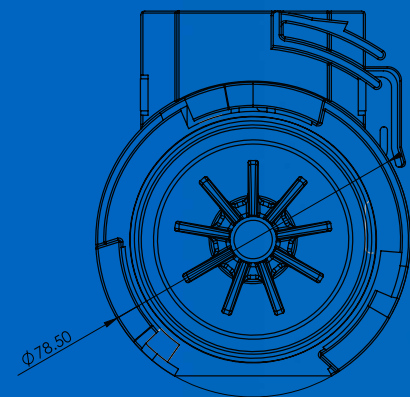
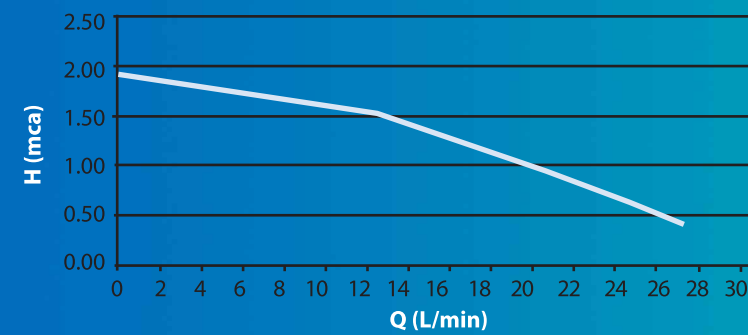

EBS

Stator Stack 25 mm.

Common pump, suitable for all drain applications up to 1m of pressure drop.

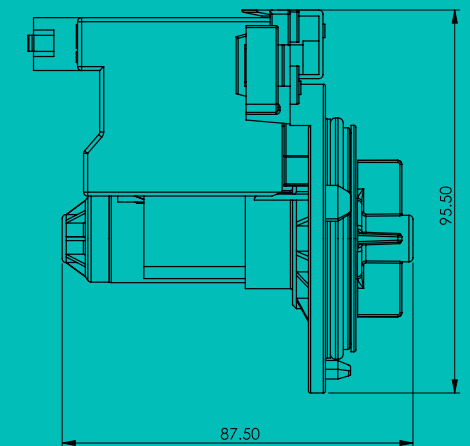
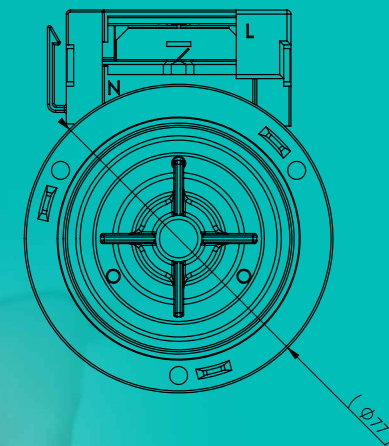
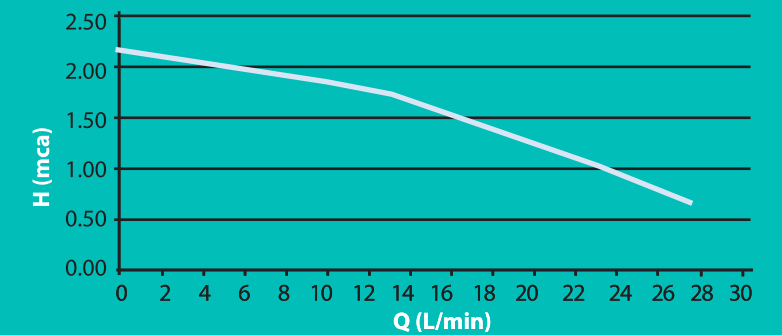

BEBS

Stator Stack 40 mm.

Biggest pump suitable for heavy duty applications or if higher pressure drop is required.

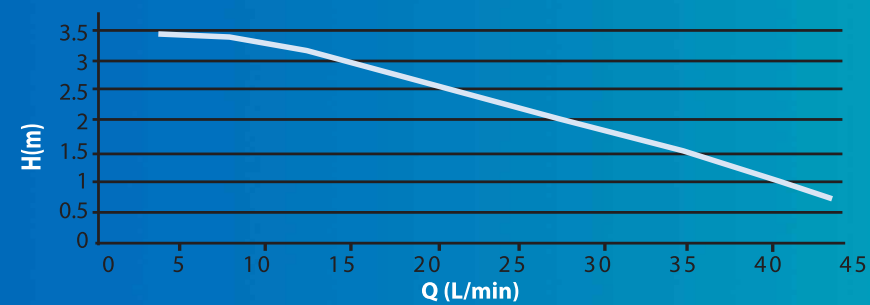

BLP3

Electric drain pump with compact design and improved hydraulic performance. High starting torque, no clutch needed.

